

[Electric stapler]

Electric stapler "RAPID"

Electric stapling machines are used in day-to-day work in many offices, mail rooms, copying rooms and many areas of the industry. Our electric staplers are the perfect choice for large-volume stapling

In our range you will find the professional electric stapling machines "Rapid". Quality controlled to give you superior long-lasting performance, our stapling machines are designed for heavy-duty applications. These staplers meet the requirements of operators needs in the office as well as in the industry. With our electric staples Rapid, you will be able to make print shops work in your own office!

Typical applications are:

- Stapling of documents up to 80 sheets
- In-door production of product catalogues, folders and brochures
- Production of mailings
- Print shop near applications
- Commercial packaging work like blister packaging
- Closing of plastic bags and sales packaging



Electric stapler "Rapid 100"

Our electric stapler Rapid 100 is the perfect choice for large-volume stapling, wherever productivity is valued. The R100E is a reliable classic stapling machine with a sturdy design.

With a capacity of 50 sheets, this stapler meets most requirements in the office and the packaging industry. The variable impact force makes it versatile to various applications. Like all electric stapler of the brand "Rapid", the R100E is quality controller to give you superior long-lasting performance. This stapler has a great cost/performance ratio making it to the most sold electric stapler worldwide.

This electric stapler is used in the office as well as for industrial works, especially in the packaging industry and in the production for finishing blister packaging. The stapling depth is adjustable up to a maximum of 85 mm, for even more productive work, this stapler can be upgraded with a pedal.

Advantages:

- Functional – suitable for offices and industry
- Quality – sturdy design for long service life
- Variable impact force
- Adjustable stapling depth (up to 85 mm)
- Safe to use – no stapling when head guard is lifted
- Reliable, double-trigger sensors for automatic stapling
- Two-position stapling anvil (stapling and pinning)
- Rubber feet ensure quiet and stable stapling
- User-friendly: simple front-loading magazine
- Pedal-operated (extra option) for efficient works

Technical details

Kapazität:	up to 50 sheets (80 g/m ²)
Klammern:	210 staples Rapid 66/6-8 150 staples Rapid 44/6-8
Hefttiefe:	up to 85 mm - adjustable
Gewicht:	3.600 g
Spannung / Frequenz:	220 V / 50 Hz
Abmessungen:	A: 270 mm B: 130 mm C: 150 mm

[Electric stapler Rapid 105]

Electric stapler "RAPID"

Electric stapler "Rapid 105"

Our electric stapler Rapid 105E is a fast, versatile and almost silent electric stapler for various applications in business and industry. It is very powerful and due to the quality controlled manufacturing, extremely reliable.

Its slim design enables it to be installed in a variety of configurations for extra versatility. This thin construction allows you to staple small, slim packs automatically or ped-operated. Two and more stapling units can be mounted inline (serial) for time-saving stapling. In this case, the stapling units are connected with an opto cable for simultaneous and most cost effective stapling. A lot of additional accessories is available to ease the working process. Especially for packaging applications in the industry, this stapler is the choice of the professional user.

The stapling depth is adjustable up to a maximum of 100 mm. The impact force is also adjustable to your requirements. The front loading mechanism is fast and convenient. The head guard assures safe and reliable stapling.

Technical details:

Stapling capacity:	up to 50 sheets
Magazine capacity:	210 staples 66/6-8+
Stapling depth:	up to 100 mm - adjustable
Weight:	3600 g
Dimensions (with base):	250x100x240 mm
Dimensions (without base):	250x60x225 mm
Power supply:	220 V/50 Hz
Extra options:	See aside



Advantages:

- Two or more staplers can be combined
- Flexible – slim and compact design
- User-friendly – low noise level, special stapling technology
- Adjustable stapling depth
- Adjustable impact force
- Quality – reliable operation, precise stapling
- Safe – Head guard to protect the user
- A lot of accessories and extra options
- Fast and convenient front loading mechanism
- Double trigger sensors, individually adjustable

Additional options:

- Pedal for industrial applications
- Opto cable (40 or 70 cm) for simultaneous stapling
- Bench clamb to firmly fix the stapler to work table
- Industrial multi base for mounting up to 4 staplers
- Stapling head exchangeable easily



[Electric stapler Rapid 106]

Electric stapler "RAPID"

Electric stapler Rapid 106

Our electric stapler Rapid 106 is the professional electric stapler for office and industrial applications. Similar built to the R105E, this stapling machine includes a flexible work table for flat and saddle stapling. With this stapler, you will buy three staplers in one, allowing you flat stapling, loop stapling and saddle stapling with one stapler only.

With our stapler R106E, you can easily staple brochures or folders in two ways. With the work table folded down, you will reach a standard stapling, with the work table folded up, saddle stapling is also possible. For saddle stapling, another feature is possible with this stapler. The R106E also allows you to use loop-staples with an extra stapling head. The staple head is easy to change within a few seconds.

Its slim design enables it to be installed in a variety of configurations for extra versatility. This thin construction allows you to staple small, slim packs automatically or ped-operated. Two and more stapling units can be mounted inline (serial) for time-saving stapling. In this case, the stapling units are connected with a opto cable for simultaneous and most cost effective stapling. A lot of additional accessories is available to ease the working process. Especially for packaging applications in the industry, this stapler is the choice of the professional user.

The stapling depth is adjustable up to a maximum of 100 mm. The impact force is also adjustable to your requirements. The front loading mechanism is fast and convenient. The head guard assures safe and reliable stapling.

The electric stapler R106E is a real professional stapler and meets all

Technical details:

- Stapling capacity:** up to 50 sheets
- Magazine capacity:** 210 staples 66/6-8
- Throat depth:** up to 100 mm - adjustable
- Weight:** 4200 g
- Dimensions (1):** 250x60x438 mm (narrow work table)
- Dimensions (2):** 250x250x438 mm (wide work table)
- Power supply:** 220 V / 50 Hz
- Standard equipment:** Wide work table, foot switch
- Extra options:** See aside



Advantages:

- Three staplers in one
- flat stapling, loop stapling, saddle stapling
- Flexible – slim and compact design
- User-friendly – low noise level
- Adjustable stapling depth
- Adjustable impact force
- Quality – reliable operation, precise stapling
- Safe – Head guard to protect the user
- A lot of accessories and extra options
- Fast and convenient front loading mechanism
- Double trigger sensors, individually adjustable
- Pedal supplied as standard equipment

Additional options:

- Opto cable (40 or 70 cm) for simultaneous stapling
- Stapling head for loop stapling
- Rail for saddle stapling
- Narrow work table (60 mm) with anvil



[Electric stapler Rapid 5050]

Electric stapler "RAPID"

Electric stapler Rapid 5050

The electric stapler Rapid 5050 is an electric flat clinch stapler of the newest generation with a huge number of innovative components.

Our stapler Rapid 5050 is a dependable, high-capacity electronic stapler that exceeds the standards of quality and performance. With this stapler, you can easily clinch between 2 and 50 sheets of paper. It is ideal for busy offices, mailrooms and home use as the stapling is carried out very quiet and with low vibration. The small footprint of the machine saves space on your working desk.

The very new stapler cartridge simplifies the reloading. Each cartridge comprises 5000 staples, all wear parts are replaced with each fresh cartridge. This new technology also allows precise stapling due to the flat clinch of the staples.

Our electric stapler Rapid 5050 is very durable and comes with a sturdy plastic cover.

Technical details:

Capacity:	up to 50 sheets
Staples:	Cartridge Rapid 5050
Stapling depth:	Adjustable - up to 50 mm
Weight:	2200 g
Operating power:	220 V / 50 Hz
Size:	A: 270 mm
	B: 130 mm
	C: 150 mm

Cartridge - How to change?

One staple cartridge comprises 5000 staples and the most important wear parts. With every staple cartridge, these parts are also removed to enlarge the life span of your stapling machine.

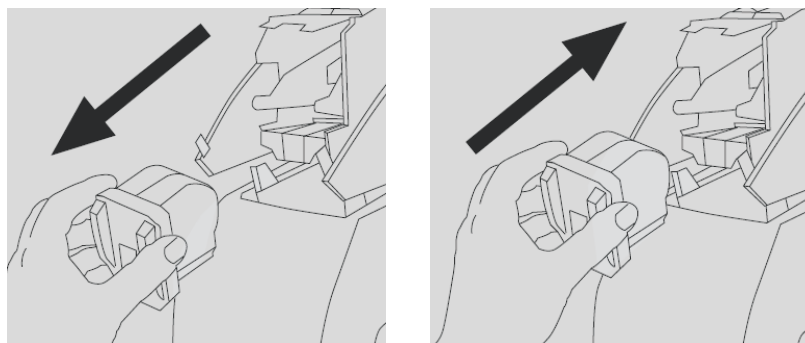

Advantages:

- Suitable for office and industry
- Large capacity (5000 staples)
- Robust construction for long durability
- Guarantees 500,000 actuations
- Exchange of the wearing parts with each cartridge
- Adjustable stapling depth
- Protective cap for sure work
- user-friendly front load mechanism
- Foot trigger for rational work available
- Stylish design
- 2-year manufacturer's guarantee

Additional options:

- Foot trigger
- Stable working table
- Coloured cover



[Electric stapler Rapid 5080]

Electric stapler "RAPID"

Electric stapler Rapid 5080

The electric stapler Rapid 5080 is an electric flat clinch stapler of the newest generation with a huge number of innovative components for stacks of a maximum of 80 sheets.

Our stapler Rapid 5080 is a dependable, high-capacity electronic stapler that exceeds the standards of quality and performance. With this stapler, you can easily clinch between 2 and 80 sheets of paper. It is ideal for busy offices, mailrooms and home use as the stapling is carried out very quiet and with low vibration. The small footprint of the machine saves space on your working desk.

The very new stapler cartridge simplifies the reloading. Each cartridge comprises 5000 staples, all wear parts are replaced with each fresh cartridge. This new technology also allows precise stapling due to the flat clinch of the staples.

Our electric stapler Rapid 5080 is very durable and comes with a sturdy plastic cover.



Technical details:

Capacity:	up to 80 sheets
Staples:	Cartridge Rapid 5080
Stapling depth:	Adjustable - up to 50 mm
Weight:	2200 g
Operating power:	220 V / 50 Hz
Size:	A: 270 mm
	B: 130 mm
	C: 150 mm

Advantages:

- Suitable for office and industry
- Large capacity (5000 staples)
- Robust construction for long durability
- Guarantees 500,000 actuations
- Exchange of the wearing parts with each cartridge
- Adjustable stapling depth
- Protective cap for sure work
- user-friendly front load mechanism
- Foot trigger for rational work available
- Stylish design
- 2-year manufacturer's guarantee

Cartridge - How to change?

One staple cartridge comprises 5000 staples and the most important wear parts. With every staple cartridge, these parts are also removed to enlarge the life span of your stapling machine.

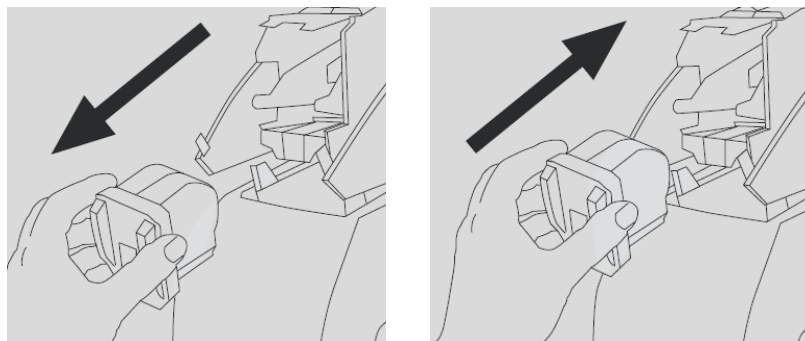

Additional options:

- Foot trigger
- Stable working table
- Coloured cover

